

Green and digital transition in TVET in the construction sector

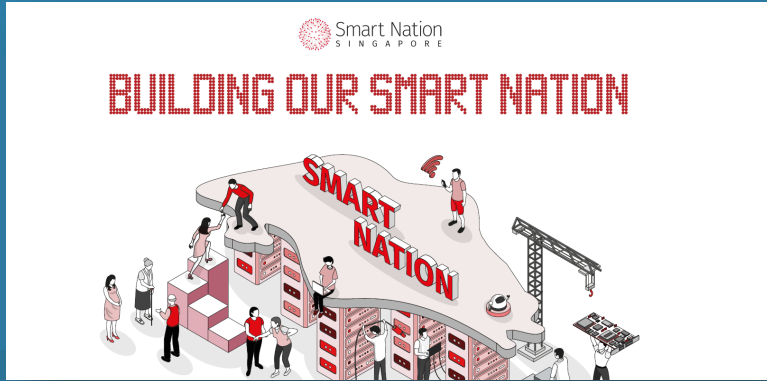

National Programmes that affect digitalizing and greening TVET



Singapore Smart Nation

- Develop a digital-first Singapore is one where a Digital Government, Digital Economy and Digital Society harness technology to effect transformation in health, transport, urban living, government services and businesses.



Singapore Green Plan 2030

- A whole-of-nation movement to advance Singapore's national agenda on sustainable development.
- Charts ambitious and concrete targets to advance Singapore's national agenda on sustainable development in five key pillars: City in Nature, Sustainable Living, Energy Reset, Green Economy and Resilient Future

National Programmes that affect digitalizing and greening TVET

INDUSTRY TRANSFORMATION MAPS

A strategy to promote growth and competitiveness for 23 industries. Each Industry Transformation Map (ITM) integrates productivity improvement, skills development, innovation and internationalisation. To be developed and implemented in partnership with industry partners, they will help to achieve our vision for the sectors and create good jobs for Singaporeans.

www.mti.gov.sg/MTIInsights/Pages/ITM.aspx

EDUCATION AND TRAINING PROVIDERS

GOVERNMENT

PRODUCTIVITY AND INNOVATION CENTRES

COMPANIES

INDUSTRY ASSOCIATIONS

INNOVATION

- Leverage technology to drive innovation and value-creation
- Build enterprise capabilities and sector infrastructure
- Develop own products and brands

INTERNATIONALISATION

- Develop core of globally-competitive local enterprises
- Access global markets through digital channels
- Leverage international networks for market access

PRODUCTIVITY

- Shift towards higher-value added activities
- Drive operational excellence
- Establish shared industry platforms for mass adoption

DESIRED OUTCOMES

FOR COMPANIES

- Strategies that provide integrated assistance across domains
- Stronger support for innovation and internationalisation
- Single govt agency to integrate transformation efforts

FOR WORKERS

- New and re-designed jobs with better wages
- More opportunities overseas
- Stronger support for upgrading and skills deepening

23 INDUSTRIES

- Energy & Chemicals
- Precision Engineering
- Marine & Offshore
- Aerospace
- Electronics
- Construction
- Environmental Services
- Real Estate
- Security
- Air Transport
- Sea Transport
- Land Transport
- Logistics
- Healthcare
- Education
- Professional Services
- ICT and Media
- Financial Services
- Food Services
- Retail
- Hotels
- Food Manufacturing

MTI MINISTRY OF TRADE AND INDUSTRY SINGAPORE

Information correct as of September 2016

- Under the S\$4.5 billion Industry Transformation Programme (ITM), roadmaps are developed for 23 industries to address issues within each industry and deepen partnerships between Government, firms, industries, trade associations and chambers.
- Each ITM consists of a sector-specific growth and competitiveness plan, covering areas such as productivity, internationalisation, innovation, digitalisation, and jobs and skills.

Industry Transformation Map (Construction)

Vision: An advanced and integrated sector with widespread adoption of leading technologies, led by ***progressive and collaborative firms*** well-poised to capture business opportunities, and supported by a skilled and competent workforce offering ***good jobs for Singaporeans***.

- ITM identifies Integrated Digital Delivery (IDD), Design for Manufacturing and Assembly (DfMA), as well as green building as key transformation areas to address the challenges faced by the sector.
- The transformation of the sector will result in redesigned jobs involving higher skills, more competitive salaries and better work environment to meet the aspirations of Singaporeans

Architectural Technology and Building Services Diploma Programme



This 3-year course equips students with the necessary multi-disciplinary skill sets to design and manage smart and sustainable buildings for tomorrow's cityscape.

Students will also get to experience how technology is used in sustainable architecture and systems design, for today's digital economy.

Architectural Technology and Building Services Diploma Programme

The course focuses on 3 unique fields aligned to Singapore's industry transformation map

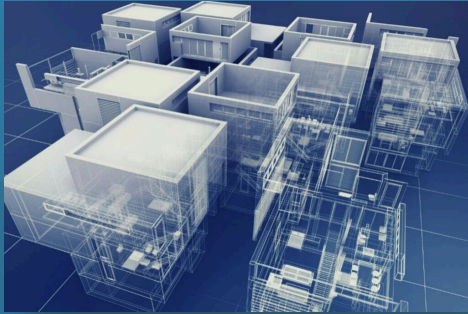

Digital Architecture

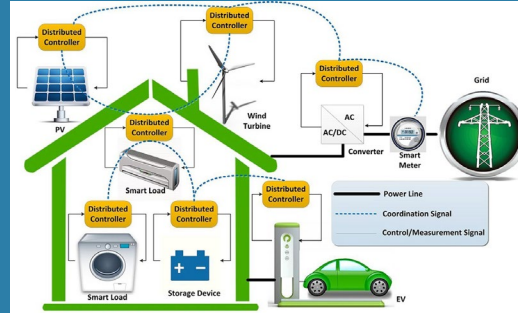

Energy Management



Sustainability

Smart Technologies and Systems in IBEC



The Integrative Built Environment Centre (IBEC)'s comprehensive facilities make it the most complete set-up of its kind in any polytechnic. It provides students with access to the latest digital architectural design and engineering simulations to facilitate their learning, learn how technology and digitalisation are used to design smart and sustainable buildings for the future.

The IBEC also promotes collaborations among students, staff members and industry partners from diverse capabilities. Altogether, around 1,000 pre-employment training (PET) and 1,000 continuing education and training (CET) students will train at IBEC annually.

Uniqueness of IBEC



Live Systems to Plug and Play

Within its live environment, IBEC enables “plug and play” for learning with technology and data-driven facility management systems, exposing students to the latest technologies and industry demands so that they understand the importance of timely interventions within an authentic environment.



Interdisciplinary Learning and Partner Collaborations

Tapping on various disciplines in architecture, design, engineering and information technology, IBEC is designed for interdisciplinary learning and promotes collaborations among students, staff and industry partners across a broad range of capabilities.



Our Partners



NEC



LINGJACK
DIGITAL
Innovation and Value thru' Technology

SKILLSFuture SG



IBEC's comprehensive facilities make it the most complete set-up of its kind in any polytechnic. The two studios here also provide students with access to the latest digital architectural design and engineering simulations to facilitate their learning.



AI-Enabled Security System



Lift and Escalator Systems



Electric Vehicle Laboratory



Studios (Building Information Modeling Studio and Building Performance Studio)



Dr Adrian Ang, Head of Integrative Built Environment Centre

“Before this facility, our students had to learn everything from the textbook in a classroom setting.”

“This means that they were not able to see for themselves how certain problems or solutions play out in real life, which limits their understanding because they would just accept the theoretical calculations rather than be prompted to ask further questions and experiment.” Dr Adrian Ang



“It really puts everything (the different systems) together, which helps us understand the whole journey of how a building develops, as opposed to being taught the different components separately in a classroom.” Sara Tan

Architectural assistant Sara Tan has been training at the Integrative Built Environment Centre

Looking through the lens of 3 “I”s

Identification: Singapore Smart Nation Plan, Singapore Green Plan 2030 and Industry Transformation Map (Construction) inform the key focuses, priorities, strategies and outcomes of TVET (construction) in Singapore

Integration: Collaboration with industry partners in IBEC and through IBEC

Implementation: Live and authentic environment in IBEC to inject realism in learning

Thank you

Lim_Teng_Leng@tp.edu.sg